

SONIC
DUALTRON
MODEL N

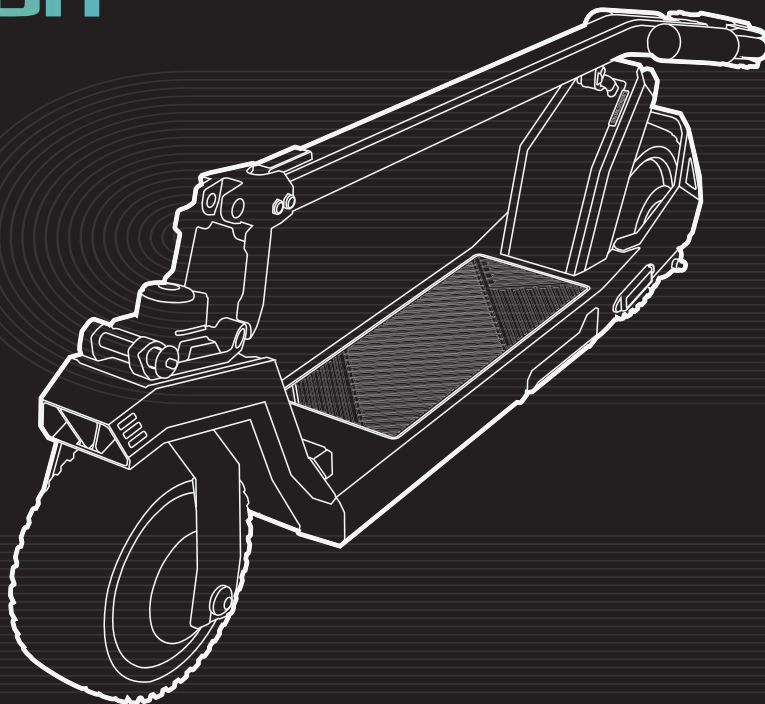

Personal Mobility

PRODUCT MANUAL





Scan the QR code to download the latest user materials
and obtain the latest updates and safety instructions.

DUALTRON

The dream of electric technology.

Pictures for reference only, subject to our existing products.



MINIMOTORS



Diagram And Functions

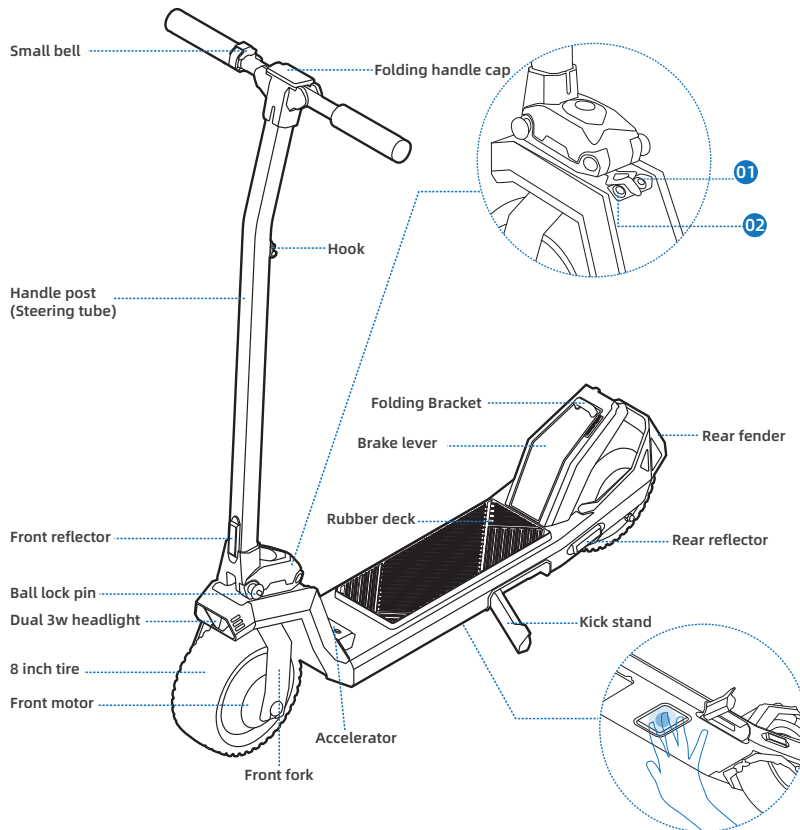

MAINS

01 Power switch

Long press to power on/off,
short press to toggle the headlight.

02 High capacity

Medium capacity

Low capacity

Red light flashing (very low capacity)

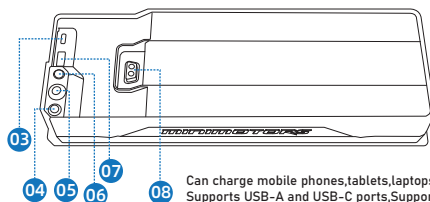

Can charge mobile phones, tablets, laptops,
Supports USB-A and USB-C ports, Supports fast
charging up to about 100W.

BATTERY

03 TYPE C

Power
On/off button

07 TYPE A

04 Battery indicator light

06 42V Charge port

08 Main charge and
discharge port



Specifications

	Item	Parameter
Product	Model	Dualtron sonic model n
Battery	Battery Capacity	36V4Ah (CN) 36V10.2Ah(SAMSUNG)
	Range	11km 30km
	Charging Ambient Temperature	0 to 40°C (Battery temperature exceeds 55°C,BMS start protection program.)
	Battery Management System	Over-heating, short circuit, over-current, over-discharge and over-charge protection
Rider	Max. load	100kg
	Recommended Age	16-60 years old
	Required Height	3'11" -6'6" (120-200 cm)
Motor	Motor Type	Hub motor
	Nominal Power	350W x2
Machine	Net Weight	14kg 14.7 kg
	Max. Slope	Around 26.8%[15°]
	Drive System	Dual motor drive
	Speed	25km/h
	Length × Width × Height	888×453×1093mm(Without number plate)
	Folded: Length × Width × Height	1010×186×355mm
	Wheelbase	Approx.700mm
	Ground Clearance	Approx.52mm
	Traversable Terrain	Asphalt/flat pavement; obstacles < 5 cm; gaps < 5 cm
	Operating Temperature	-20°C—60°C
	Storage Temperature	-20°C—60°C



Specifications

Brake	Machine Brake	Mechanical cdouble sided disc brake
	Electric Brake	EBS (Indicating the battery temperature exceeds 55°C,BMS start protection program,EBS fails.)
Charger	Input Voltage	100-240VAC
	Max. Output Voltage	41.5V1.5A
Tire	Type	(self-sealing tire)8inch
	Tire Pressure	2.5bar
	Material	Rubber

*Disclaimer: this is not a legal opinion or legal advice. The information provided herein (including in the App) is for your convenience and information purpose only. It is not intended to cover every piece of law and/or regulation that may be applicable to this product. DUALTRON explicitly hereby disclaims any and all warranty and/or representation, express or implied, related to completeness, accuracy, up-to-date of such information. DUALTRON reserves the right but not obligation to correct, implement and/or update the information. You shall use the information at your own risk. It is your sole responsibility to learn and understand any and all the law and/or regulation, requirements, prohibition, restriction and/or limitation imposed by either law, government authority, court, private party or the others that may apply to your use of this product.

*Theoretical Range: tested while riding with a full battery, 75 kg load, 25°C, at the speed of 25 km/h on average on pavement.

*Typical Range: tested while riding with a full battery, 75 kg load, 25°C, at the speed of 50 km/h on average on pavement. (Some of the factors that affect range include speed, number of starts and stops, ambient temperature, etc.)

*Max.Speed: tested while riding with a full battery,75kg load,25°C,straight road on flat road with no wind. (Some environmental factors can affect max speed,un-even roads, crooked roads, temperature, wind, etc.)

The specific driving parameters of the vehicle,you can view it yourself after connecting to the APP.



Packing List

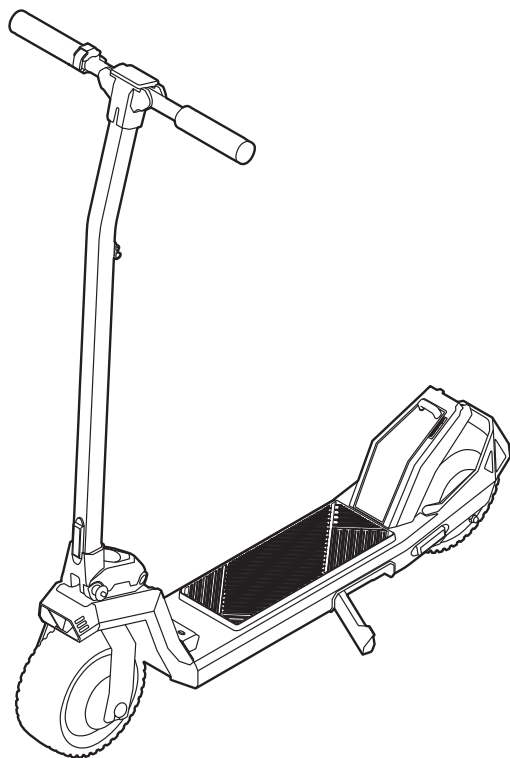

Accessories



Main battery charger x1

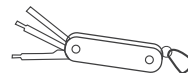

Multitool x 1



Manual



2 screws



Assembly

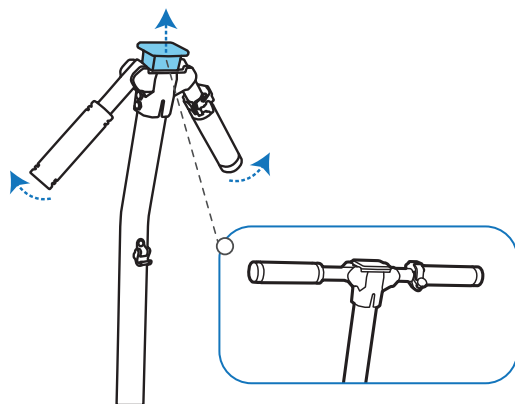

Take out the vertical pole, lift the folding handle cap, and unfold the handle upwards.

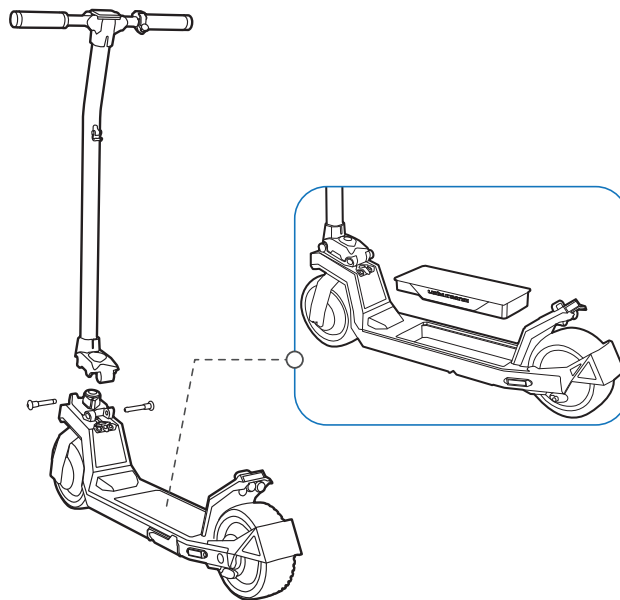

Place the pole into the hole according to the position shown in the picture, then press and hold the quick release lever into the corresponding empty position, and finally put the battery into the battery slot to complete the assembly.

Bluetooth Connection

APP Download Guide

Method 1

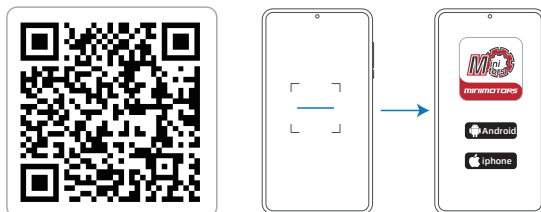

1. Scan the QR code to download the APP.
2. Choose the mobile phone system that suits you to install, and register / log in.

Method 2

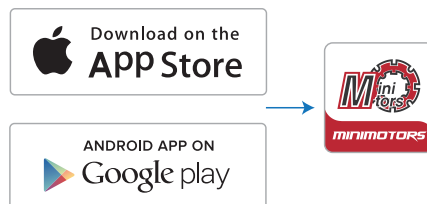

1. Search "DUALTRON" in the application and download it, and register / log in.

Pair the Bluetooth on the APP

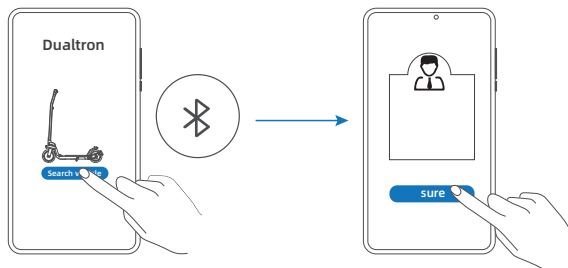

Click "Search vehicle" and pair with your scooter. * The scooter is connected to the Dualtron app when the Bluetooth symbol lights up.

Select "bind as owner".
(No one else can connect, only people authorized by you are allowed to connect. Authorizations are created on the app.)



How to Ride

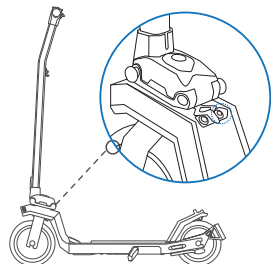

1. Short press for 2-3 seconds to turn on.



2. Since this electric scooter defaults to a non-zero start mode, you first need to use your back foot to gently slide forward for a distance, and at the same time step on the accelerator with your front foot to start the scooter.

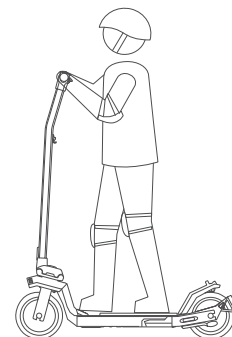

3. When driving, keep your center of gravity balanced, lightly press the accelerator with your front foot, and gradually increase the intensity to accelerate smoothly. At the same time, pay attention to the road conditions to ensure safe driving.

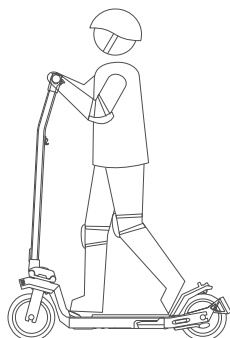

4. When you need to slow down or stop, slightly tilt your center of gravity back and gently depress the inclined brake on the rear of the scooter with your back foot without releasing the accelerator.

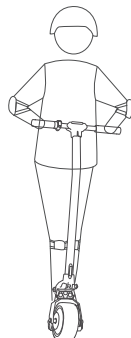

5. When turning, gently turn the scooter's pole. When the pole turns to a 15° angle, the turn signal will automatically light up to alert people and vehicles around you to your turning.



When hard braking, serious danger or injury may occur. Maintain a moderate speed and look out for potential hazards.



Folding

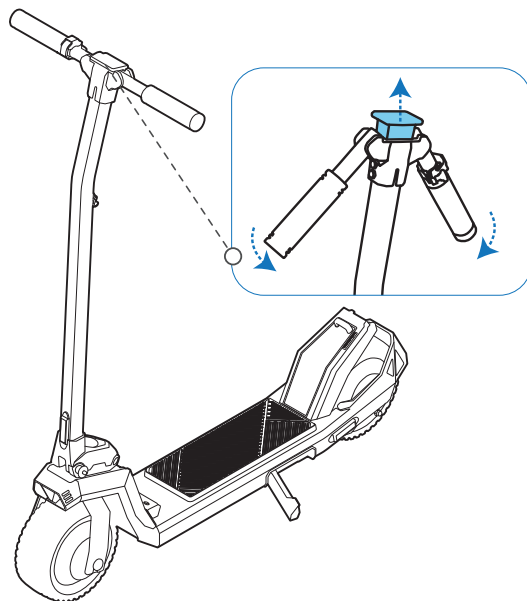

Lift the folding handle cap and fold the handle downward.

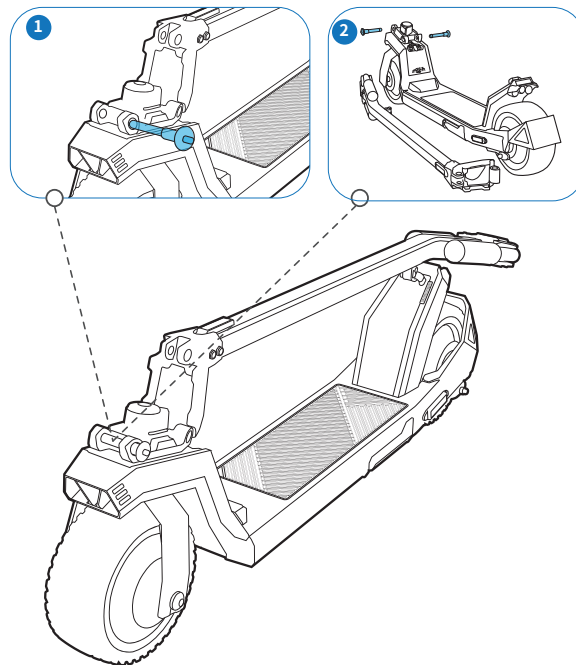

Two folding methods:

1. Press the button on the quick-release rod and take out a quick-release rod at the position shown in the picture, and the vertical pole can be folded.

2. Take out the quick-release rods at the two positions shown in the picture, and the entire vertical pole can be disassembled.

MEMO